

UIL MUSIC REGION 14
2022 VOCAL/PIANO SOLO & ENSEMBLE CONTEST
TEXAS A&M UNIVERSITY
KINGSVILLE, TEXAS
January 29, 2022

PARTICIPANT INFORMATION

DOCUMENT DISTRIBUTION

This document contains important information regarding the 2022 UIL Vocal/Piano Solo & Ensemble Contest on January 29, 2022. Directors receiving this packet should read all information carefully and share it as appropriate with staff members, administrators, student, parents, and other stakeholders who have an interest in the event.

CONTACT INFORMATION, DAY OF EVENT:

Bill Cason, Region 14 Executive Secretary
361-946-6432

COVID PROTOCOLS

All participants, directors, and school chaperones are asked to follow the CDC guidelines and recommendations currently in place for aiding the prevention of spread of COVID-19.

SCHEDULE

The Final Contest Schedule is included in this packet. Two contest rooms had some shifting between schools in morning performance slots. All directors involved in those swaps have been notified. There were NO OTHER changes in the DRAFT schedule that was previously distributed to directors.

BUS UNLOADING AND PARKING

There is a bus loading/unloading zone on Armstrong Street at the main entrance to the Music Building. Students should be unloaded at that location and then vehicles should move to the old music building to park for the duration of the contest. Directors should have a method of communication with drivers so they can be contacted to return to the bus zone to pick up students when each school has completed competition. See the Site Map that is included in this Packet.

DIRECTOR CHECK-IN

Directors must check-in at the Contest Office (Admin Suite) inside the Music Building as soon as they arrive. Enter the Building on the Armstrong Street side where the buses load. Turn right in the hallway, the Contest Office is about 20 steps down the hall and on your right. At the Contest Office, each Director will:

1. Turn in the Form 1 (List of eligible students), **signed by the campus principal**
2. Receive the Judging Forms (Form 6) from a member Contest Official
3. Take **ANY AND ALL SHEETS OF ABSENT (DNA) student/ensembles**, write "DNA" on them and return those sheets to a Contest Official

4. Place the remaining Form 6's in performance order and deliver them to their assigned Contest room(s)
5. Report any changes in Ensemble Members
6. Make **SURE** that you bring **ORIGINAL MUSIC** for the Judges for **EVERY** solo and ensemble that is being performed, and that the **MEASURES ARE NUMBERED**

CONTEST ROOMS

All the Contest Rooms this year are large rehearsal or performance areas to help provide the safest possible environment for everyone's safety. It is expected that all participants will show respect for each other and help maintain that environment. There will be a "safe space" designated for a table or desk in each room for music and sheets to be placed for the exchange of documents between students, directors, monitors, and judges. Please use it as needed.

CHECK-OUT

Check out moves quickly at this event, but **ONLY** if all your judging sheets are in the Contest Office. Since most schools have all their students competing in the same room, Directors should know when the last event has performed. Ask the monitor to collect all the sheets from your school and get them to the Contest Office quickly so that the checkout process can begin. Also, be **CERTAIN** that someone from your school is designated to collect all your music from the Judge. (Perhaps your accompanist could do that task?)

WEATHER CONDITIONS

A series of cold fronts late this week bring predictions of cold weather, in the 30's, for early Saturday morning. However, this forecast also includes clear sunny skies with temperatures warming into the 60's by late morning, early afternoon. Be prepared for a variety of temperatures, as students will be encouraged to move outside as soon as weather conditions permit.

Good luck to everyone and have a safe trip Saturday.

**UIL MUSIC REGION XIV
CHOIR AND PIANO SOLO & ENSEMBLE
CONTEST SCHEDULE**

FINAL
1/26/22

Saturday, January 29, 2022
Texas A&M University, Kingsville

Judge #1: ***Craig Jones***
Room: **181 (JAZZ ROOM)**

8:30 – 12:30 Seale JH-Robstown (52)

1:30 – 2:30 Calallen MS (11)
2:30 – 2:45 Calallen HS (4)
2:45 – 5:30 Carroll HS (28)

Judge #2: ***Matt Garcia***
Room: **160 (BAND HALL)**

8:30 – 9:00 Seale JH-Robstown (14)
9:00 – 10:10 Adams MS-Alice (15)
10:10 – 10:15 Gillett MS-Kingsville (1)
10:15 – 11:30 HM King HS (13 + 2 Ens)
11:30 – 12:30 Miller HS (10)

1:30 – 2:30 Moody HS (11)
2:30 – 5:30 Robstown HS (32)

Judge #3: ***Omar Samaniego***
Room: **156 (ORCHESTRA ROOM)**

8:30 – 10:00 G-P HS (16)
10:00 – 12:30 Flour Bluff HS (28)

1:30 – 3:15 Vet Mem HS (19)
3:15 – 5:30 Ray HS (21 + 1 Ens)

Judge #4: ***Naida Ramsey***
Room: **200 (CHOIR ROOM)**

8:30 – 11:15 G-P HS (20 + 8 Ens)
11:15 – 12:30 Flour Bluff HS (10 + 2 Ens)

1:30 – 5:30 Vet Mem HS (30+7+1 Med)

Judge #5: ***Becky Terrazas***
Room: **180 (RECITAL HALL)**

8:30 – 8:50 G-P HS (2 Piano)
8:50 – 10:30 Miller HS (15 Piano)
10:30 – 12:00 R King HS (17 Vocal)

1:30 – 1:45 Moody HS (2 Piano)
1:45 – 2:45 Vet Mem HS (7 Piano)
2:45 – 3:40 Ray HS (6 Piano)
3:40 – 4:30 Alice HS (11)
4:30 – 5:00 West Oso MS (6)
5:00 – 5:30 West Oso HS (7)

Bus Parking on street
both sides

Engineering Ave.

Parking Lot

Car and
Bus Parking

Old
Music Bldg.

Jones
Audit.

Armstrong St.

Bus Passenger
Drop
Pick-up

New Music
Bldg.

Santa Gertrudis Ave.

Additional
Car Parking

200 - CHOIR
(2ND FLOOR)

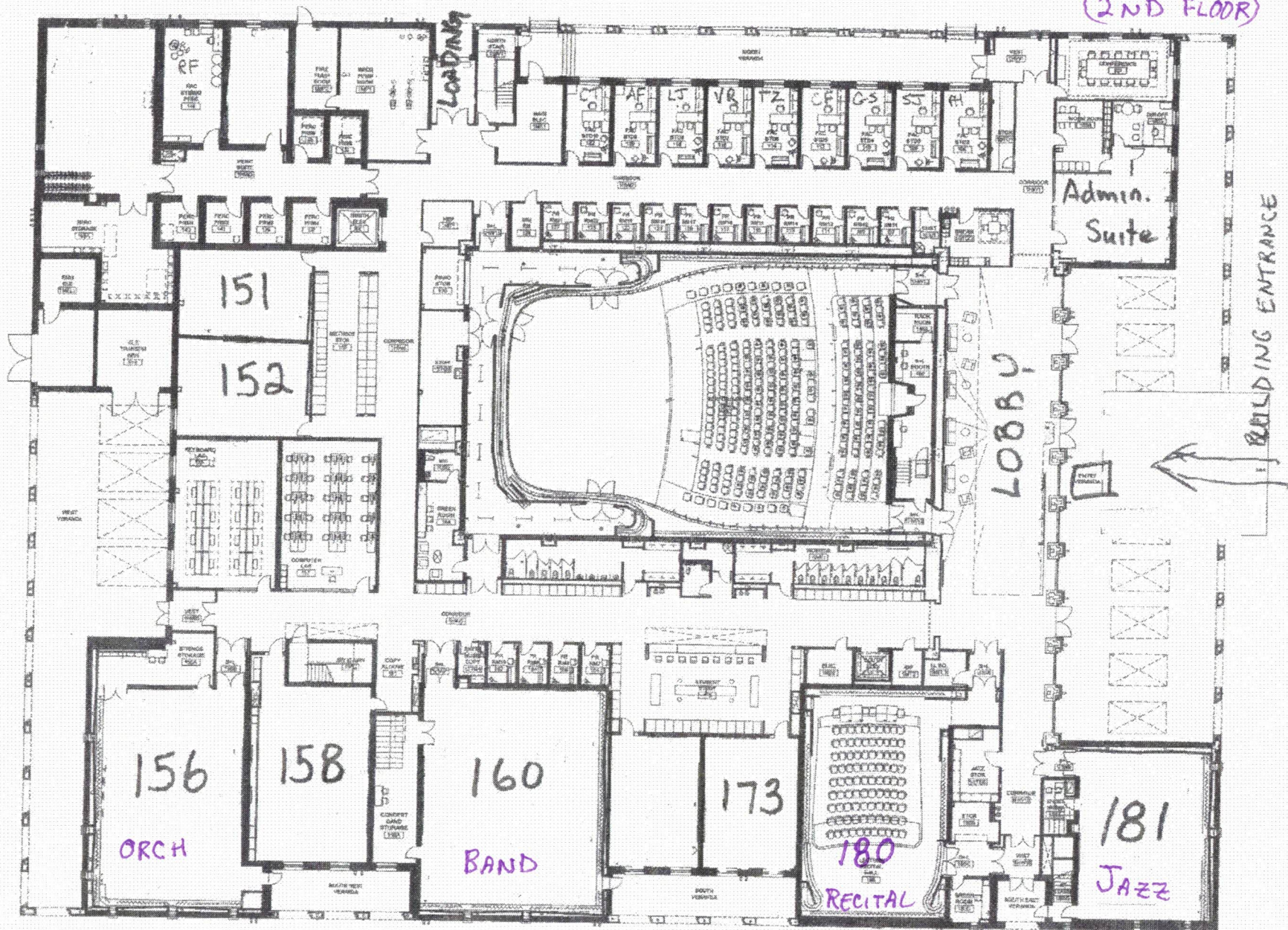

ARMSTRONG ST. (BUS UNLOADING)

1ST FLOOR

SANTA GERTRUDIS AVE